

RWI - Leibniz Institute for Economic Research is a leading centre for economic research and evidence-based policy advice in Germany. Through its research work, RWI provides information on economic developments and their underlying catalysts, assists economic policy decision-making and fosters economic literacy among the wider public.

The **health economics research department** at RWI is looking to fill a

postdoctoral position (m/f/d, 100%, pay grade TV-L E14)

in Essen, Germany.

Primary duties and responsibilities include

- conducting research in health economics and (co-)authoring scientific research articles
- collaborating on exciting and challenging third-party funded projects
- managing and acquiring new third-party funded projects
- collaborating with the doctoral students in the department and accompanying their academic development

The successful applicant will

- hold a doctoral degree or Ph.D. in economics
- have a strong interest in health economics
- have sound knowledge of microeconometrics
- be experienced in the use of statistical software packages, particularly Stata and/or R-Studio
- have successfully published in peer-reviewed journals or have conducted promising research projects
- ideally have experience in working on, acquiring and/or managing third-party funded projects
- have an excellent command of English (knowledge of German is desirable, but not required)
- enjoy working independently as well as in a team and bring a high level of self-initiative

We offer

- a challenging position in a highly motivated research team with the opportunity to contribute your own ideas, gain project management experience, enter (external) research collaborations and actively shape the public debate on economic policy
- exciting third-party funded projects in health economics and health policy as well as an extensive international network of researchers
- the opportunity to participate in international conferences as well as research stays abroad
- infrastructure and support for the analysis of large or sensitive data sets and for data management

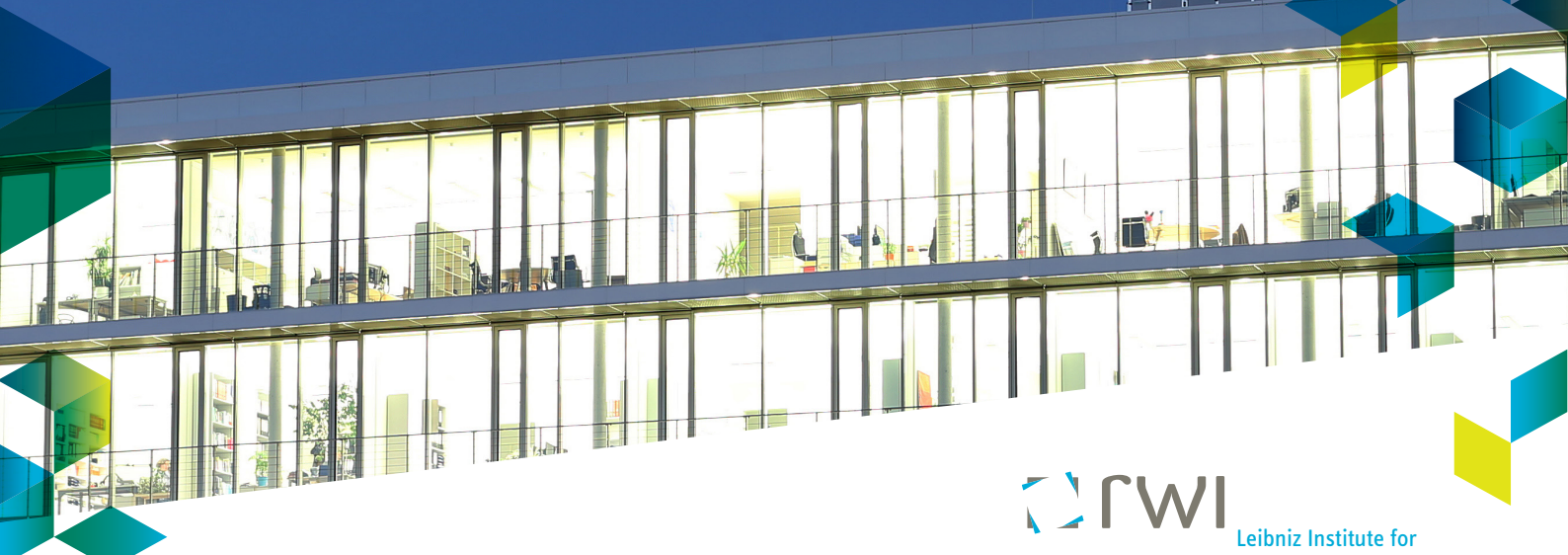

The full-time position is initially limited for up to two years, the duration of which depends on the qualification sought or on project funding. An extension of the contract is desired. The salary is based on the collective agreement for the public service of the federal states (TV-L) with special rules for employees at universities and research institutions and following the responsibilities associated with the position (pay grade E14). Compliance with the guidelines for severely disabled persons and the provisions of the law on part-time work is guaranteed. We promote professional equality of all genders.

For more information on the position, please contact Dr. Simon Decker; contact Mr. Tilo Schneider for information on the application procedure. Both can be reached at personal@rwi-essen.de.

Please submit your application documents (cover letter, CV, relevant transcripts, at least one letter of reference and up to three relevant scientific papers) ideally via e-mail, **citing reference no. 70100-31/21** until **07 January 2022** to

RWI – Leibniz-Institut für Wirtschaftsforschung

Mr. Tilo Schneider

P.O. Box 10 30 54, 45030 Essen, Germany, personal@rwi-essen.de

For more information on the institute, please visit <http://www.rwi-essen.de>.

When sending your application by e-mail, please note that your data is not encrypted and may be accessed or falsified by unauthorized persons. You are welcome to send us your documents by mail.

Essen, November 21, 2021