



**RWI - Leibniz Institute for Economic Research** is a leading centre for economic research and evidence-based policy advice in Germany. Through its research work, RWI provides information on economic developments and their underlying catalysts, assists economic policy decision-making and fosters economic literacy among the wider public.

The **research data center (FDZ) Ruhr** at RWI is looking to fill a

## **Postdoctoral position (m/f/d, 100%, TV-L E14)**

with a focus on empirical (regional) economics (especially in regional, health, environmental or labor economics)

In Essen (or our office in Berlin), Germany.

The research data center group offers an extensive set of small scale regional data and has a strong research focus on inequalities and their societal effects. Further, the data center provides data for the scientific community and is responsible for data management.

### **Tasks are**

- conducting research in regional and urban evaluations in the mentioned fields
- join us on ongoing and new research projects: recent DFG funded project on small scale Covid-19 effects and ongoing proposals
- initiating proposals in the relevant field and acquiring new third-party funded projects
- collaboration in data provision and/or data management
- collaboration with our doctoral students in the department and accompanying their academic development

### **The successful applicant should**

- hold a doctoral degree or Ph.D. in economics or a related field (completed or close to submission)
- be experienced in the use of common software as well as statistical-econometric programs (especially Stata and/or R)
- have a strong interest in empirical economics, especially in regional, health, environmental or labor economics
- have successfully published in peer-reviewed journals or have conducted promising research projects
- have very good command of English (knowledge of German is desirable, but not required)
- enjoy working independently as well as in a team and bring a high level of self-initiative

### **We offer the candidate**

- exciting third-party funded projects and an extensive international network
- a variety of activities in a dynamic research environment with many opportunities for scientific exchange and cooperation
- strong support to present research results at international conferences and facilitation of research stays abroad
- infrastructure, access and support for the analysis of large or sensitive data sets
- a wide range of continuing education and exchange opportunities

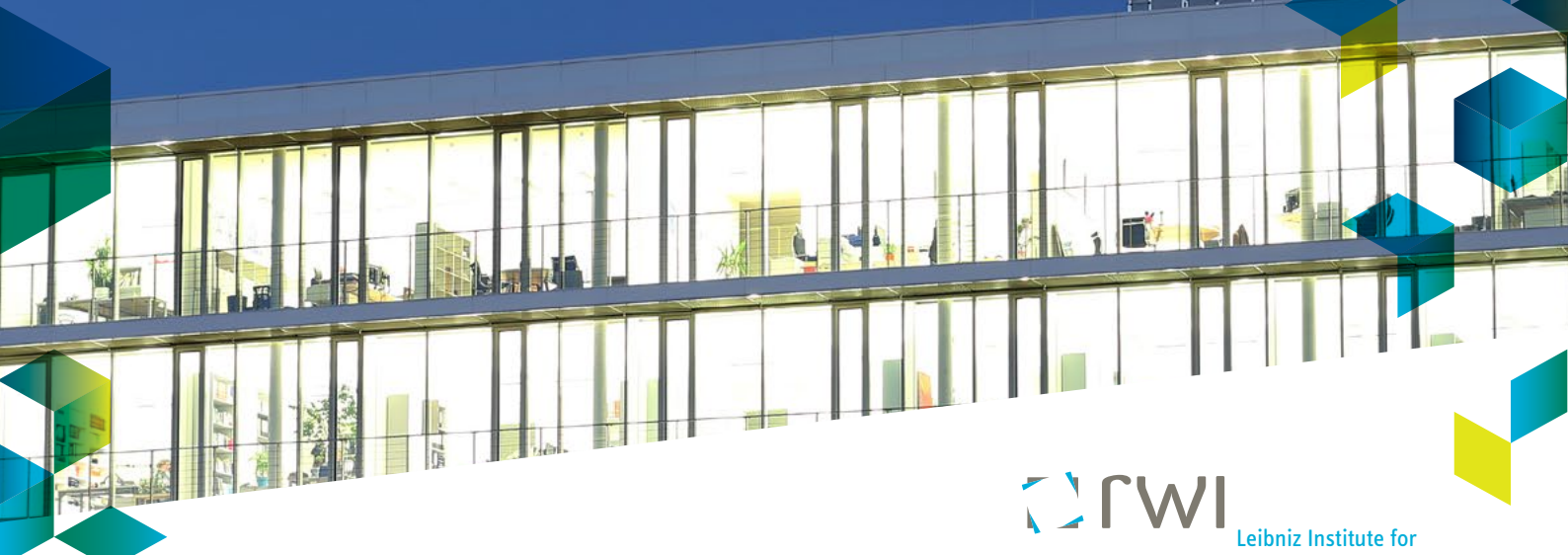

The full-time position is initially limited to two years, but an extension is desired. The remuneration is paid in accordance with the collective agreement for the public sector (TV-L) with the special rules for employees at universities and research institutions and in accordance with the responsibilities associated with the position (EG14). Compliance with the guidelines for the disabled and the provisions of the law on part-time work are guaranteed. We promote the professional equality of all genders.

For information on the position, please contact Dr. Sandra Schaffner, head of the research group, and for information on the application procedure, please contact Mr. Tilo Schneider. All can be reached at [personal@rwi-essen.de](mailto:personal@rwi-essen.de).

Please submit your application documents (cover letter, CV, relevant transcripts, at least one letter of reference and up to three relevant scientific papers) ideally via e-mail, citing **reference no. 70300-33/21** until **31 January 2022** to

**RWI – Leibniz-Institut für Wirtschaftsforschung**

**Mr. Tilo Schneider**

**P.O. Box 10 30 54, 45030 Essen, Germany, [personal@rwi-essen.de](mailto:personal@rwi-essen.de)**

For more information on the institute, please visit <http://www.rwi-essen.de>.

When sending your application by e-mail, please note that your data is not encrypted and may be accessed or falsified by unauthorized persons. You are welcome to send us your documents by mail.

Essen, December 21, 2021